

Kit 1354

SEAT Altea, 5-dr Hatchback, 04–
SEAT Toledo, 5-dr Hatchback, 05–

480R
754

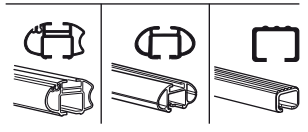
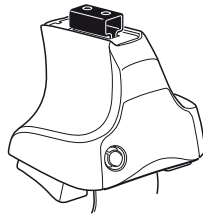

480

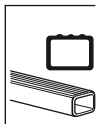
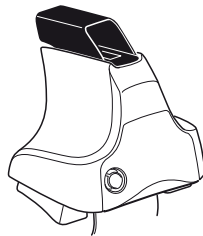

750

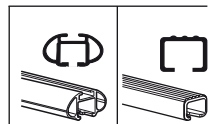
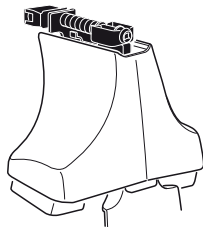

x2 x2 x2 x4	x2	x2 x2 x4 x4	x2 x2	x2

	664	x 1		74	x 1
	665	x 1		75	x 1
	301	x 2		93	x 2

Kit





1

2

	X
SEAT Altea, 5-dr Hatchback, 04–	34,5
SEAT Toledo, 5-dr Hatchback, 05–	34

1

2

	Y
SEAT Altea, 5-dr Hatchback, 04–	30,5
SEAT Toledo, 5-dr Hatchback, 05–	30,5

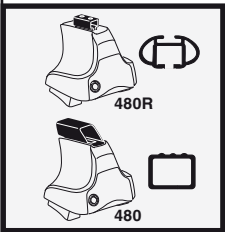

1

2

	X inch	X mm
SEAT Altea, 5-dr Hatchback, 04–	39 1/4"	996 mm
SEAT Toledo, 5-dr Hatchback, 05–	39"	991 mm

1

2

	Y inch	Y mm
SEAT Altea, 5-dr Hatchback, 04–	37 5/8"	956 mm
SEAT Toledo, 5-dr Hatchback, 05–	37 5/8"	956 mm

4

SEAT Altea, 5-dr Hatchback, 04–
SEAT Toledo, 5-dr Hatchback, 05–

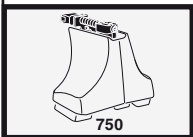
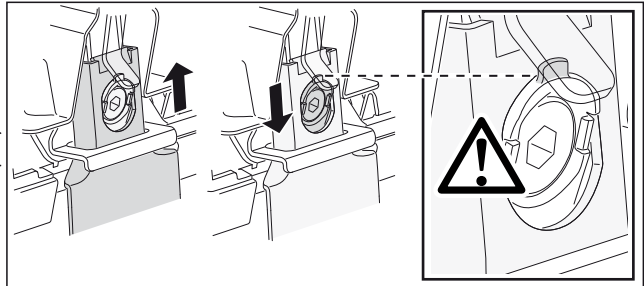
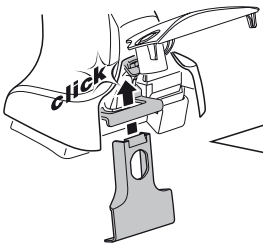
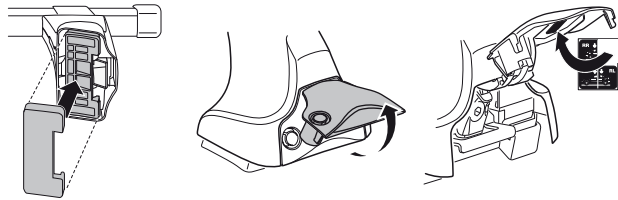
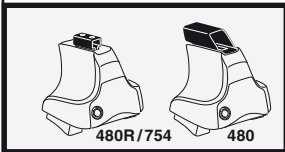
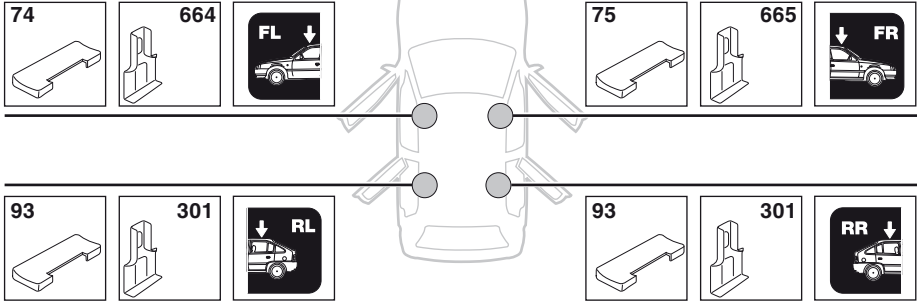

5

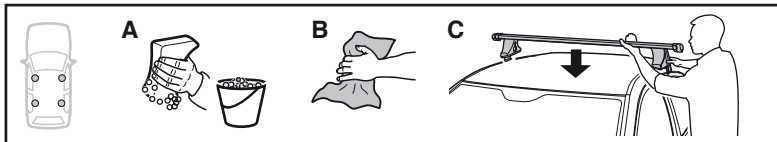

	X mm	Y mm	X inch	Y inch
SEAT Altea, 5-dr Hatchback, 04-	290 mm	700 mm	11 ³ / ₈ "	27 ¹ / ₂ "
SEAT Toledo, 5-dr Hatchback, 05-	290 mm	700 mm	11 ³ / ₈ "	27 ¹ / ₂ "

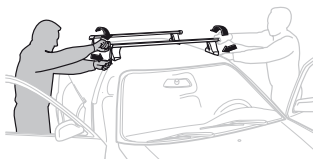
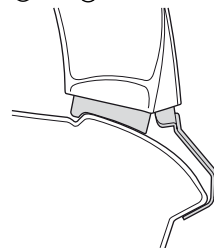
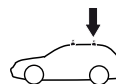
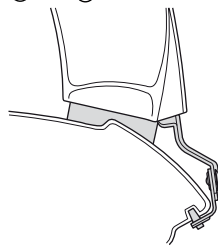
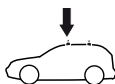
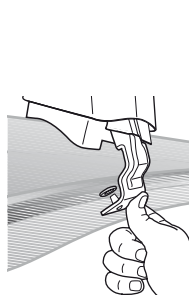
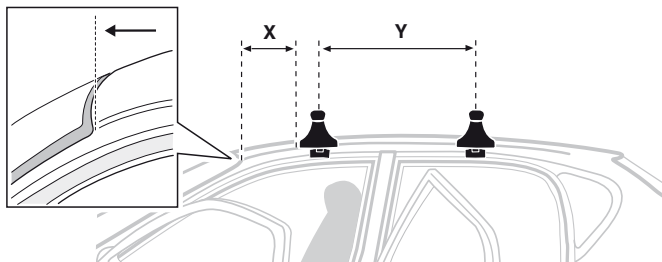

GB/US Tighten alternately
 D Die Schrauben abwechselnd anziehen
 F Serrer alternativement chaque côté
 NL Afwisselend aan de linker- en de rechterkant aandraaien
 I Alternare il serraggio delle viti
 E Apretar alternativamente
 PT Aperte alternadamente
 S Dra åt växelvis
 FIN Kierrä vuorotellen
 EST Pinguldage vaheldumisi
 LAT Pievelciēt pamišus
 LIT Užsukinėkite pakaitomis
 PL Śruby dokręcaj naprzemiennie
 RU Затягивайте попеременно

CZ Pokrétla bagażníka dokręcaj dokręcaj naprzemiennie.
 SK Dotahujte striedavo
 SLO Privijajte izmenično.
 HR Naizmjenično zategnite
 HU Egymástól függetlenül szorítandó
 GR Σφιγίγτε εναλλάξ
 TR Dönüşümlü sıkın

中文 交替拧紧

한국어 번갈아 가며 조이십시오.

日本語 交互に締め付けてください。

ไทย ชับในแบบสลับ

6



480R/754



480

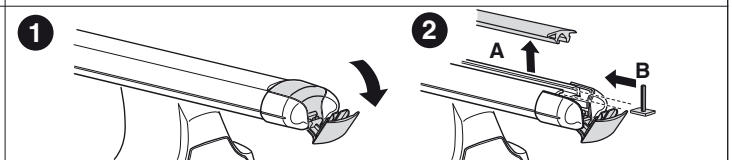
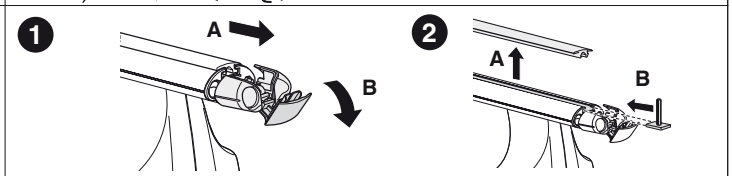
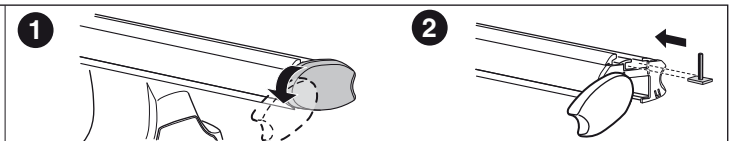
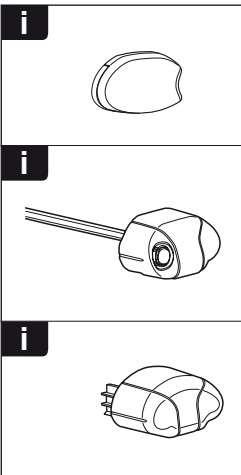
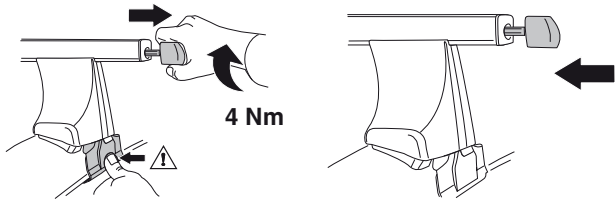
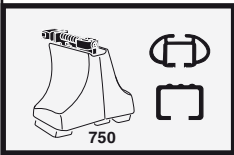
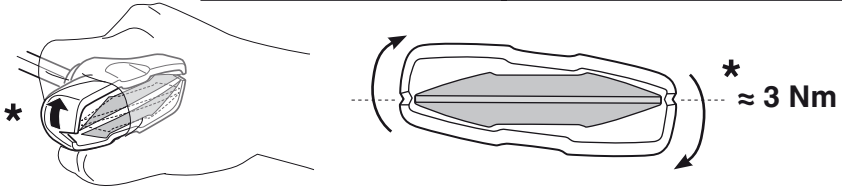
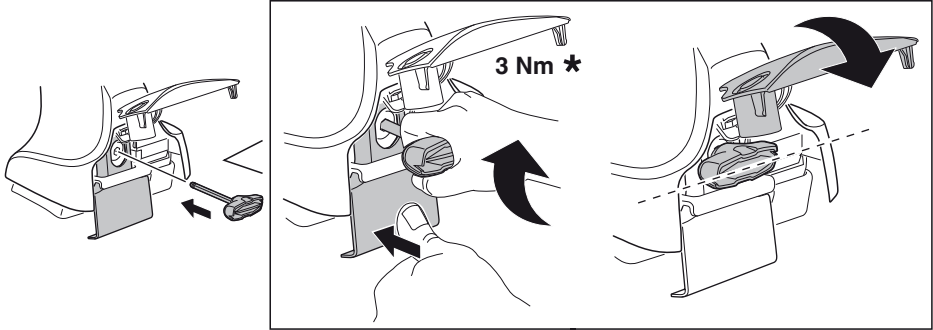

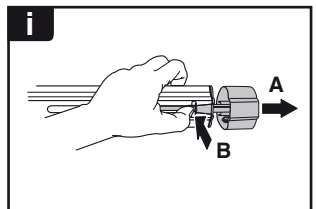
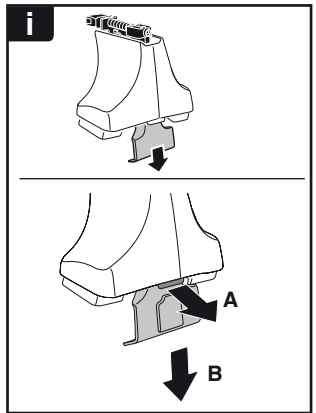
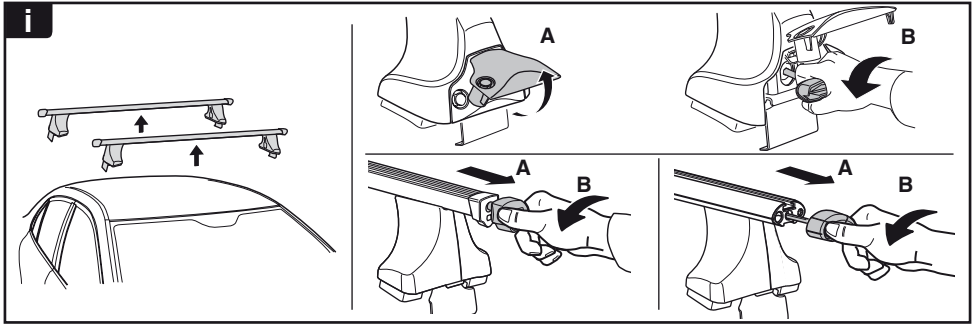

THULE
SWEDEN
**ONE
KEY
SYSTEM**



- 544 (x4)
- 596 (x6)
- 588 (x8)
- NA 510 (x10)
- EUR 452 (x12)
- ASIA



WW ▶ Thule Sweden AB, Box 69, 330 33 Hillerstorp, SWEDEN
NA ▶ Thule Inc., 42 Silvermine Road, Seymour, Connecticut 06483, USA

info@thule.com
customer.service@thule.com

www.thule.com