

Kit 1378

DACIA Logan, 4-dr Sedan, 04–

DACIA Sandero, 5-dr Hatchback, 08–

480R
754

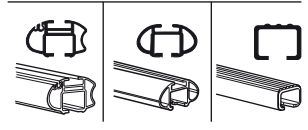
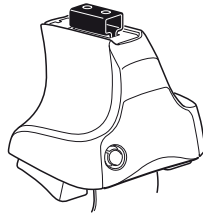

480

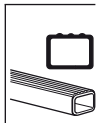
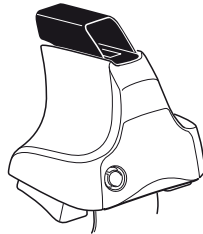

750

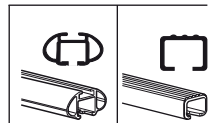
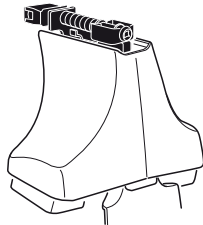

Kit



3

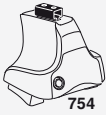

754

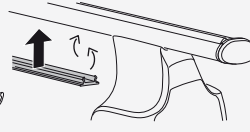
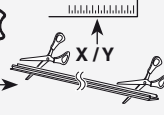

750



1

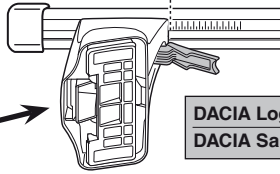
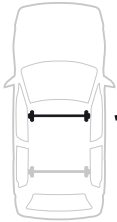

2

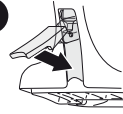

	X
DACIA Logan, 4-dr Sedan, 04-	35,5
DACIA Sandero, 5-dr Hatchback, 08-	33,5

1

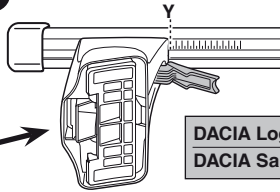

2

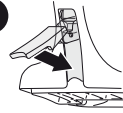

	Y
DACIA Logan, 4-dr Sedan, 04-	34,5
DACIA Sandero, 5-dr Hatchback, 08-	29,5



480R



480

1

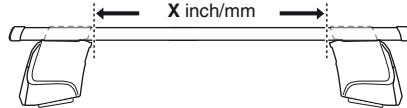
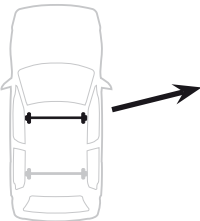

2

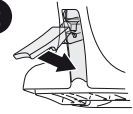

	X inch	X mm
DACIA Logan, 4-dr Sedan, 04-	39 ⁵ / ₈ "	1006 mm
DACIA Sandero, 5-dr Hatchback, 08-	38 ⁷ / ₈ "	986 mm

1

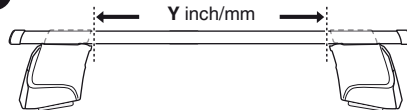
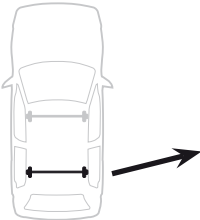

2

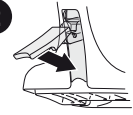

	Y inch	Y mm
DACIA Logan, 4-dr Sedan, 04-	39 ¹ / ₄ "	996 mm
DACIA Sandero, 5-dr Hatchback, 08-	37 ¹ / ₄ "	946 mm

4

DACIA Logan, 4-dr Sedan, 04–
 DACIA Sandero, 5-dr Hatchback, 08–

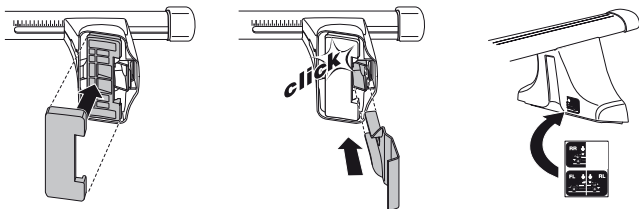
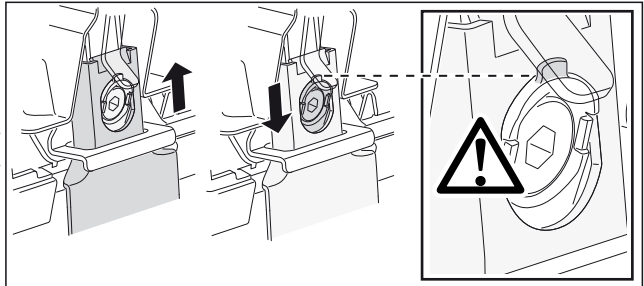
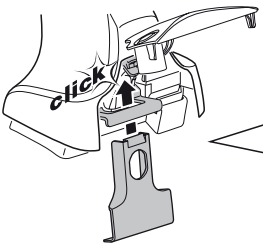
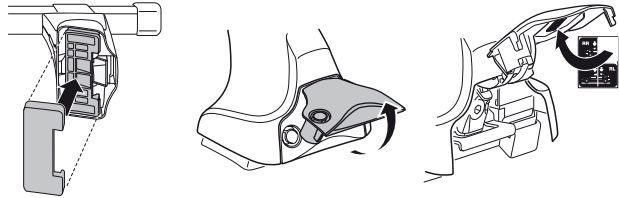
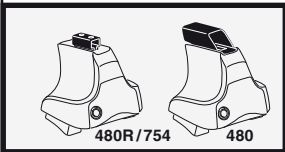
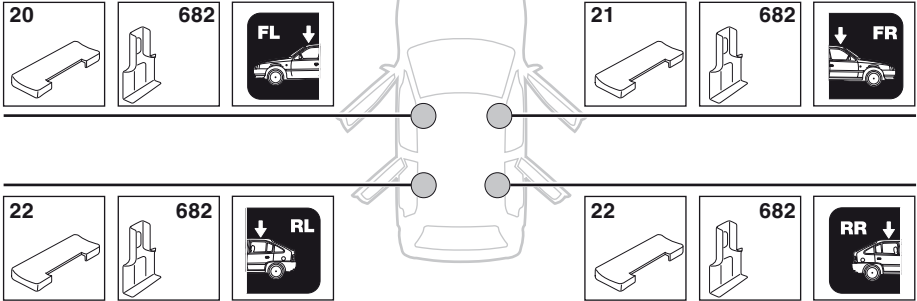

5



 x 4

 x 1

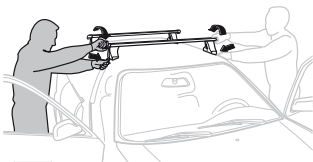
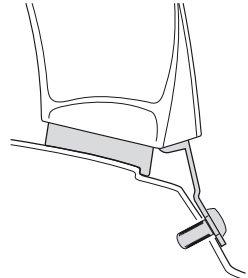
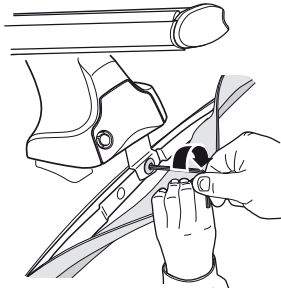
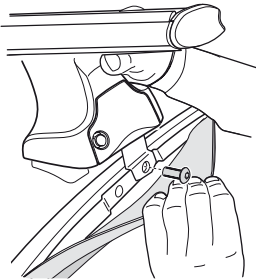
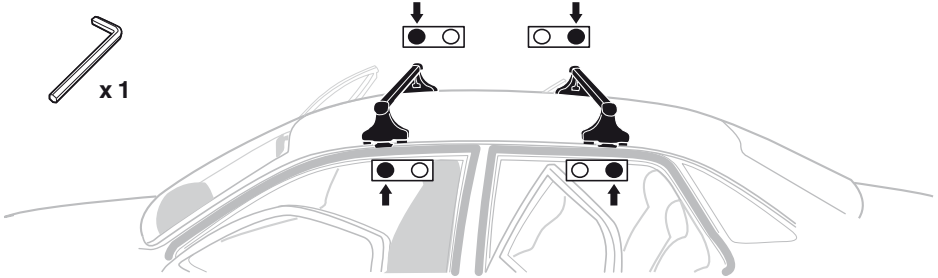

GB/US Tighten alternately
D Die Schrauben abwechselnd anziehen
F Serrer alternativement chaque côté
NL Afwisselend aan de linker- en de rechterkant aandraaien
I Alternare il serraggio delle viti
E Apretar alternativamente
PT Aperte alternadamente
S Dra åt växelvis
FIN Kierrä vuorotellen
EST Pinguldage vaheldumisi
LAT Pievelciet pamīšus
LIT Užsukinėkite pakaitomis
PL Śruby dokręcaj naprzemiennie
RU Затягивайте попеременно

CZ Pokrétla багаžníka dokręcaj dokręcaj naprzemiennie.
SK Dofahujte striedavo
SLO Privijajte izmenično.
HR Naizmjenično zategnite
HU Egy mástól függetlenül szorítandó
GR Σφιγγετε εναλλάξ
TR Dönüşümlü sıkın
中文 交替拧紧
한국어 번갈아 가며 조이십시오.
日本語 交互に締め付けてください。
ไทย ชั้ในแบบสลับ

6



480R/754



480

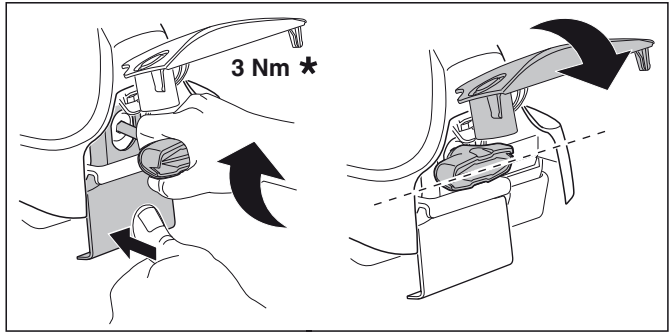
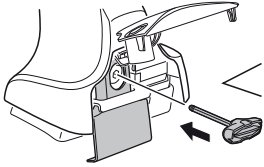

3 Nm *

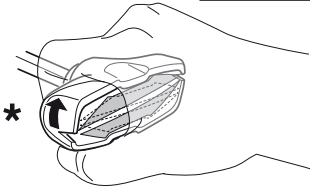

*

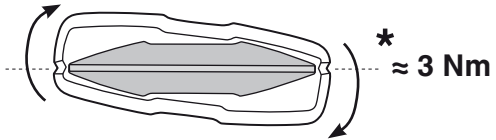

* ≈ 3 Nm



750

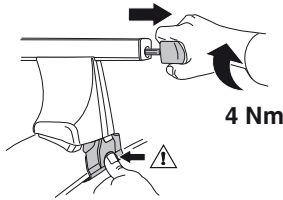

4 Nm

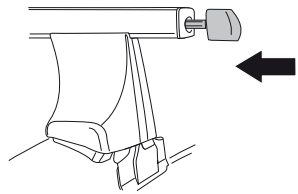

i



1



2

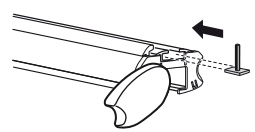

i

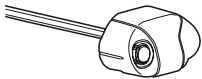

1

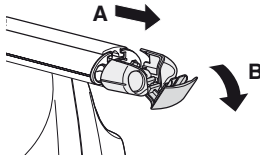

2

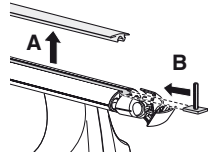

i



1

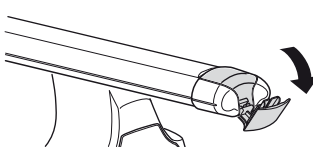



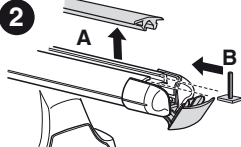

2





THULE
SWEDEN
**ONE
KEY
SYSTEM**



-  **544** (x4)
 -  **596** (x6)
 -  **588** (x8)
 -  **510** (x10)
 -  **452** (x12)
- NA
EUR
ASIA



WW ▶ Thule Sweden AB, Box 69, 330 33 Hillerstorp, SWEDEN
NA ▶ Thule Inc., 42 Silvermine Road, Seymour, Connecticut 06483, USA

info@thule.com
customer.service@thule.com

 www.thule.com