

# Kit 1405

TOYOTA Avensis, 4-dr Sedan, 03-08

TOYOTA Avensis, 5-dr Hatchback, 03-08

480R  
754

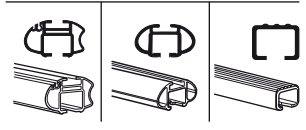
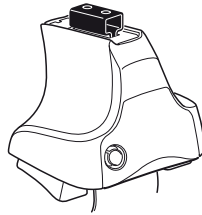

480

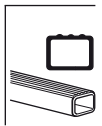
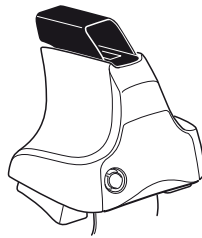

750

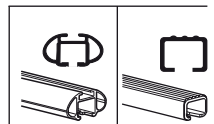
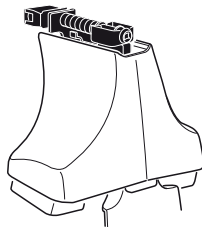

**Kit**



**3**

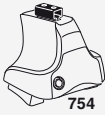

754

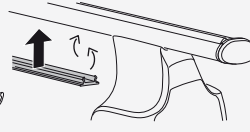
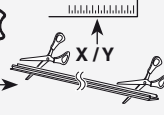

750



**1**

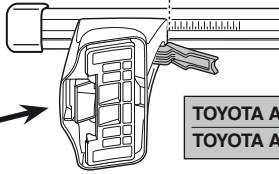
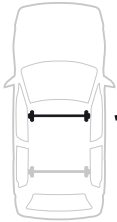

**2**



	X
TOYOTA Avensis, 4-dr Sedan, 03-08	31,5
TOYOTA Avensis, 5-dr Hatchback, 03-08	31,5

**1**

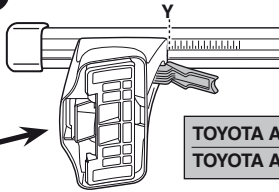

**2**

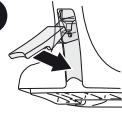

	Y
TOYOTA Avensis, 4-dr Sedan, 03-08	27,5
TOYOTA Avensis, 5-dr Hatchback, 03-08	28



480R



480

**1**

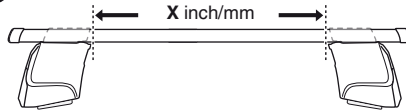

**2**

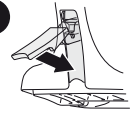

	X inch	X mm
TOYOTA Avensis, 4-dr Sedan, 03-08	38"	966 mm
TOYOTA Avensis, 5-dr Hatchback, 03-08	38"	966 mm

**1**

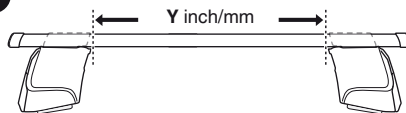

**2**

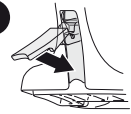

	Y inch	Y mm
TOYOTA Avensis, 4-dr Sedan, 03-08	36 1/2"	926 mm
TOYOTA Avensis, 5-dr Hatchback, 03-08	36 5/8"	931 mm

# 4

TOYOTA Avensis, 4-dr Sedan, 03-08

TOYOTA Avensis, 5-dr Hatchback, 03-08

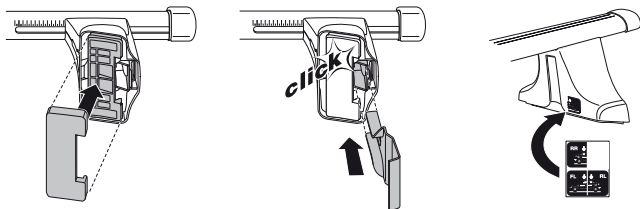
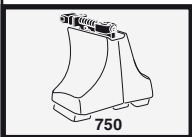
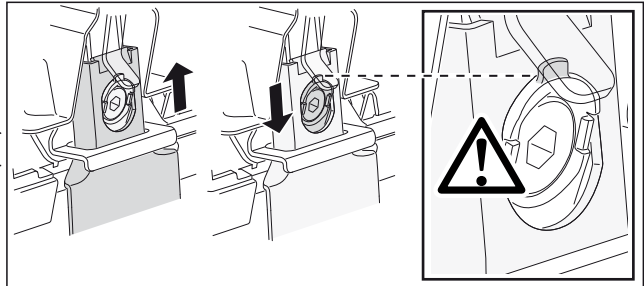
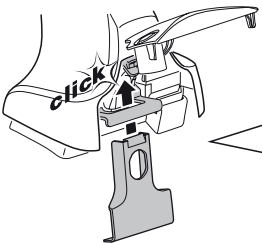
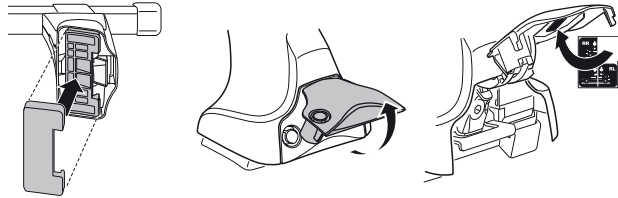
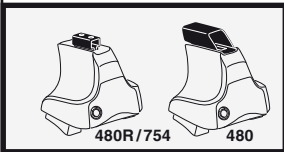
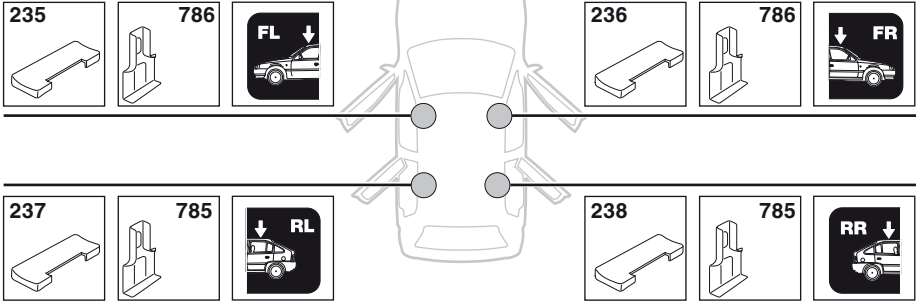

5

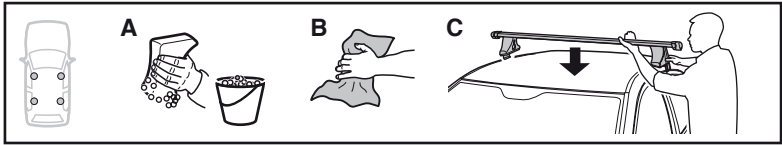

	X mm	Y mm	X inch	Y inch
TOYOTA Avensis, 4-dr Sedan, 03-08	200 mm	720 mm	7 7/8" "	28 3/8" "
TOYOTA Avensis, 5-dr Hatchback, 03-08	200 mm	720 mm	7 7/8" "	28 3/8" "

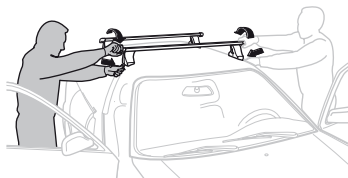
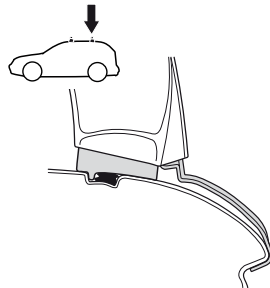
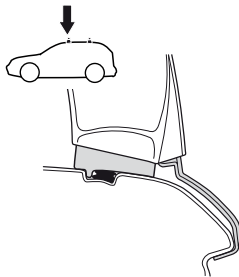
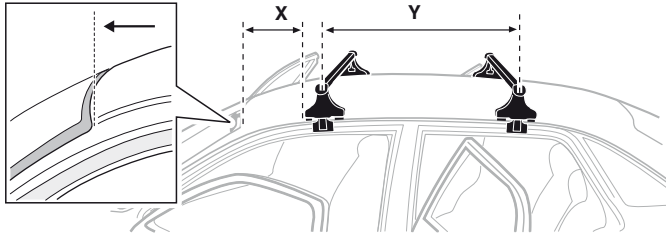

**GB/US** Tighten alternately

**D** Die Schrauben abwechselnd anziehen

**F** Serrer alternativement chaque côté

**NL** Afwisselend aan de linker- en de rechterkant aandraaien

**I** Alternare il serraggio delle viti

**E** Apertar alternativamente

**PT** Aperte alternadamente

**S** Dra åt växelvis

**FIN** Kierrä vuorotellen

**EST** Pinguldage vaheldumisi

**LAT** Pielieciet pamišus

**LIT** Užsukinėkite pakaitomis

**PL** Śruby dokręcaj naprzemiennie

**RU** Затягивайте попеременно

**CZ** Pokręťta bagażníka dokręcaj dokręcaj naprzemiennie.

**SK** Doťahujte striedavo

**SLO** Privijajte izmenično.

**HR** Naizmjenično zategnite

**HU** Egymástól függetlenül szorítandó

**GR** Σφίγγετε εναλλάξ

**TR** Dönüşümlü sıkın

**中文** 交替拧紧

**한국어** 번갈아 가며 조이십시오.

**日本語** 交互に締め付けてください。

**ไทย** ชั้้นในแบบสลับ

6

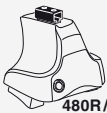

480R/754



480

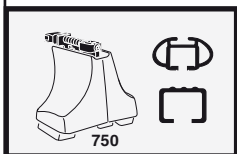
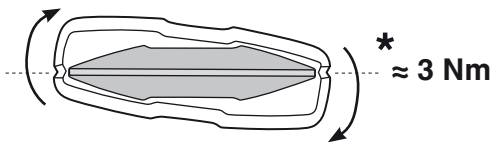
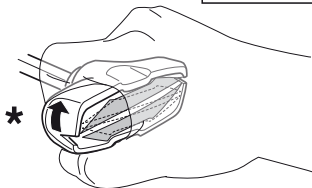
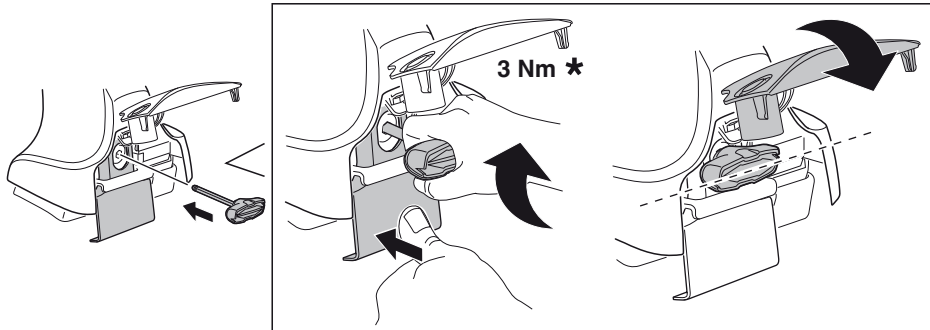

750

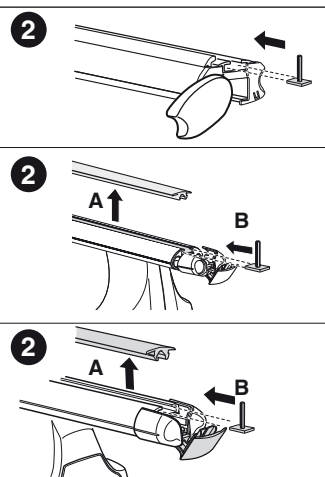
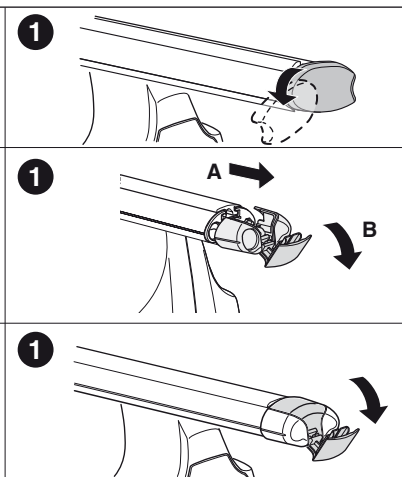
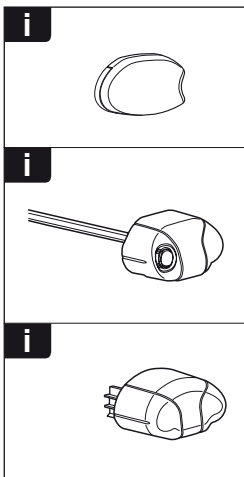
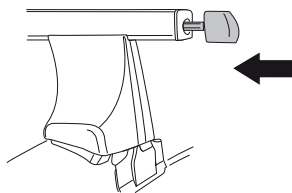
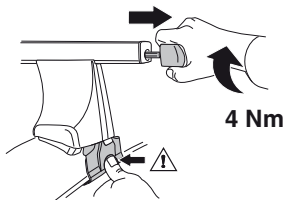



**THULE**  
SWEDEN  
**ONE  
KEY  
SYSTEM**



- 544 (x4)
- 596 (x6)
- 588 (x8)
- NA 510 (x10)
- EUR 452 (x12)
- ASIA



WW ▶ Thule Sweden AB, Box 69, 330 33 Hillerstorp, SWEDEN  
NA ▶ Thule Inc., 42 Silvermine Road, Seymour, Connecticut 06483, USA

info@thule.com  
customer.service@thule.com

www.thule.com