

Kit 1459

AUDI TT, 3-dr Coupé, 06- / *07-

*North America

480R
754

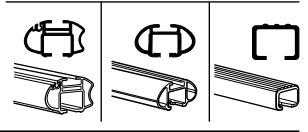
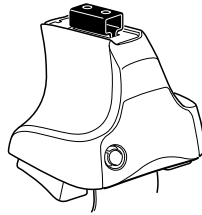

480

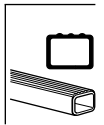
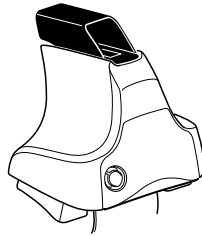

750

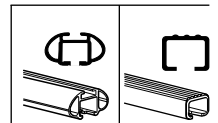
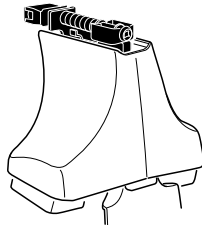

Kit



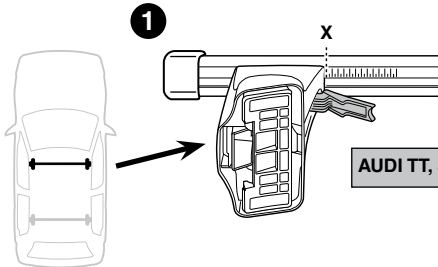

	X
AUDI TT, 3-dr Coupé, 06- / *07-	41,5

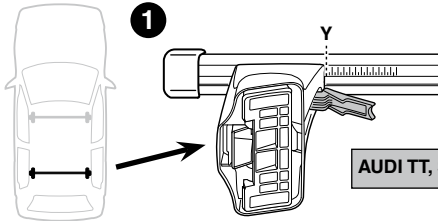
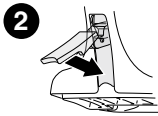

	Y
AUDI TT, 3-dr Coupé, 06- / *07-	38

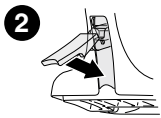
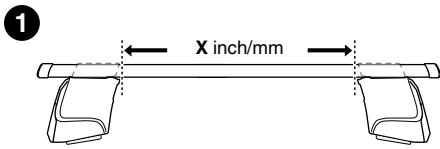
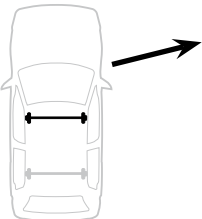
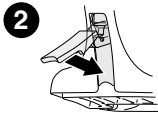

	X inch	X mm
AUDI TT, 3-dr Coupé, 06- / *07-	42"	1066 mm

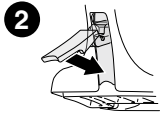
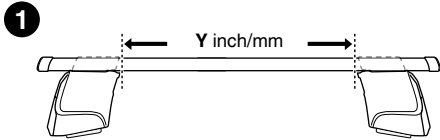
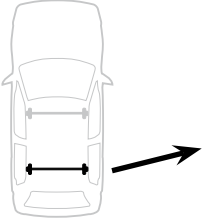

	Y inch	Y mm
AUDI TT, 3-dr Coupé, 06- / *07-	40 5/8"	1031 mm

4

AUDI TT, 3-dr Coupé, 06- / *07-

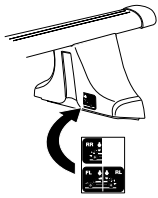
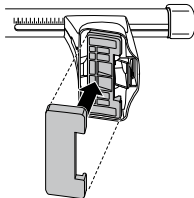
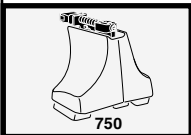
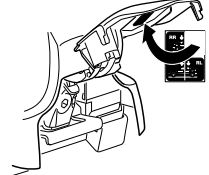
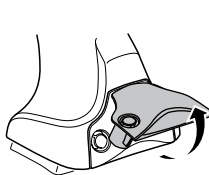
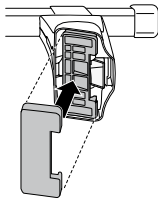
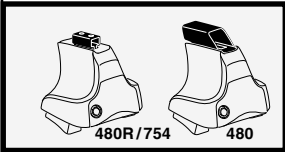
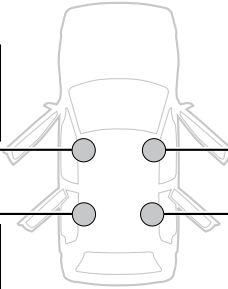

5

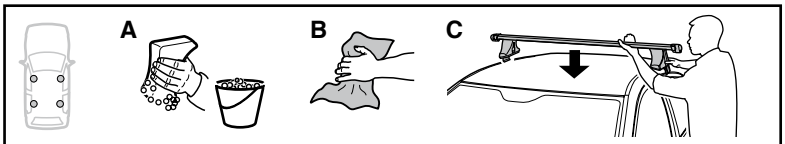

	X mm	Y mm	X inch	Y inch
AUDI TT, 3-dr coupé, 06-	15 mm	615 mm	5/8"	24 1/4"

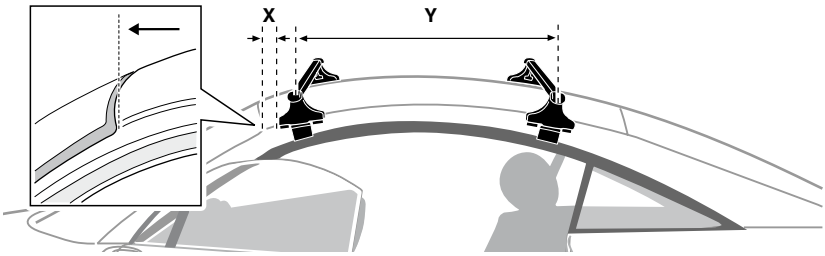

6

AUDI TT, 3-dr Coupé, 06- / *07-

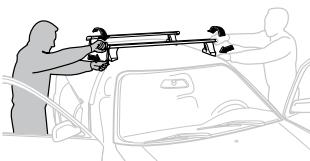
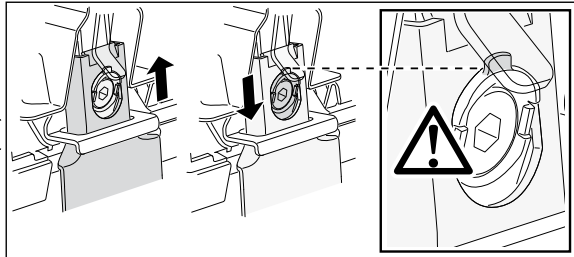
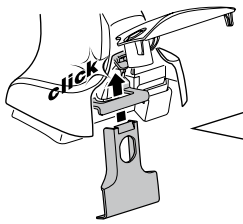
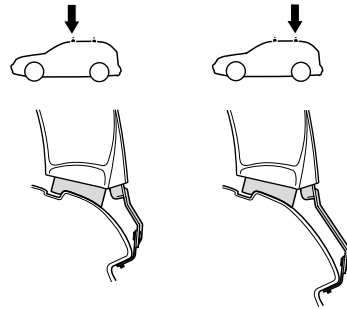
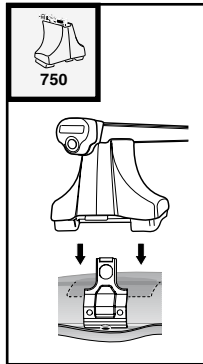
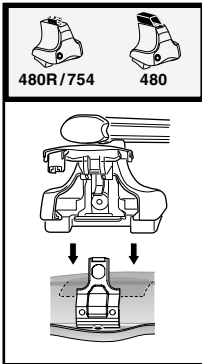
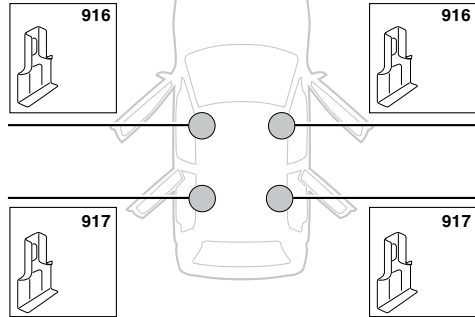
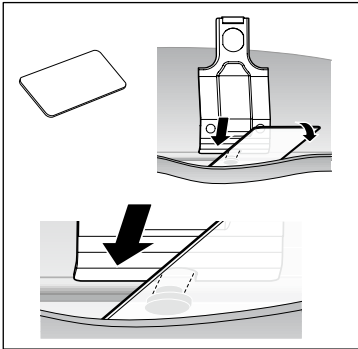

GB/US Tighten alternately
D Die Schrauben abwechselnd anziehen
F Serrer alternativement chaque côté
NL Afwisselend aan de linker- en de rechterkant aandraaien
I Alternare il serraggio delle viti
E Serrare alternativamente
PT Aperte alternadamente
S Dra át växelvis
FIN Kierrä vuorotellen
EST Pinguldage vaheldumisi
LAT Pievelciēt pamišus
LIT Užsukinėkite pakaitomis
PL Śruby dokręcaj naprzemiennie
RU Затягивайте попеременно

CZ Pokrétla bagażníka dokręcaj dokręcaj naprzemiennie.
SK Dofahujte striedavo.
SLO Privijajte izmenično.
HR Naizmjenično zategnite
HU Egymástól függetlenül szorítandó
GR Σφιγίγετε εναλλάξ
TR Dönüşümlü sıkın

中文 交替拧紧

한국어 번갈아 가며 조이십시오.

日本語 交互に締め付けてください。

ไทย ชั้้นในแบบสลับ

7

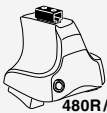

480R/754



480

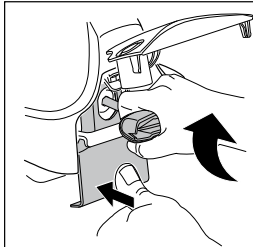
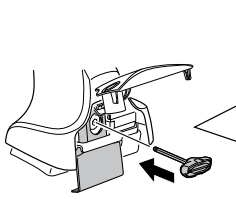
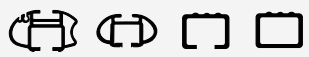

*
3 Nm

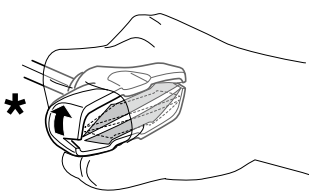
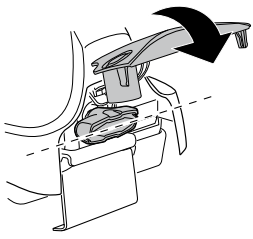

*

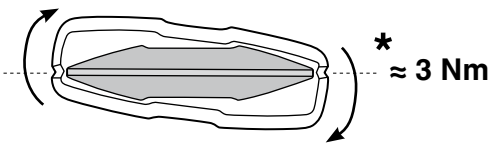

*
≈ 3 Nm

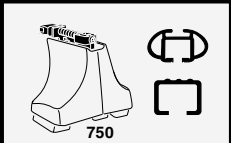
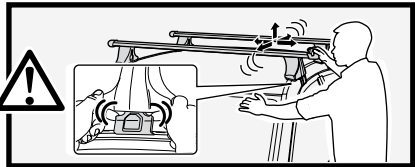

750

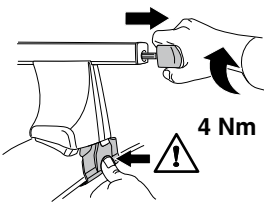

4 Nm

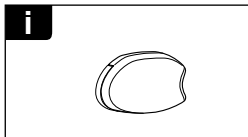
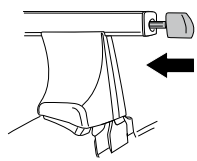

i

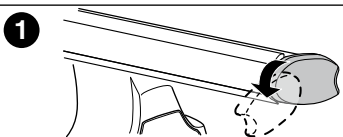

1

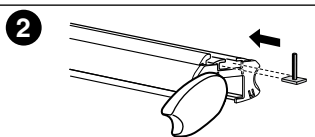

2

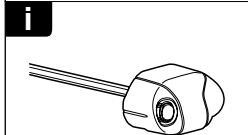

i

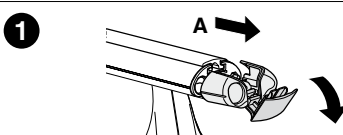

1

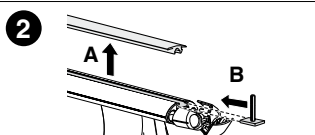

2

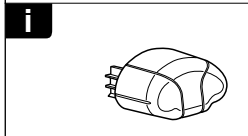

i

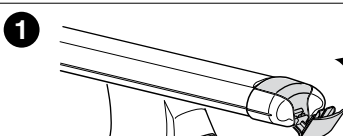

1

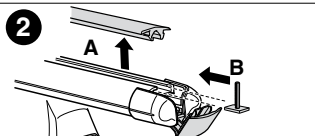

2

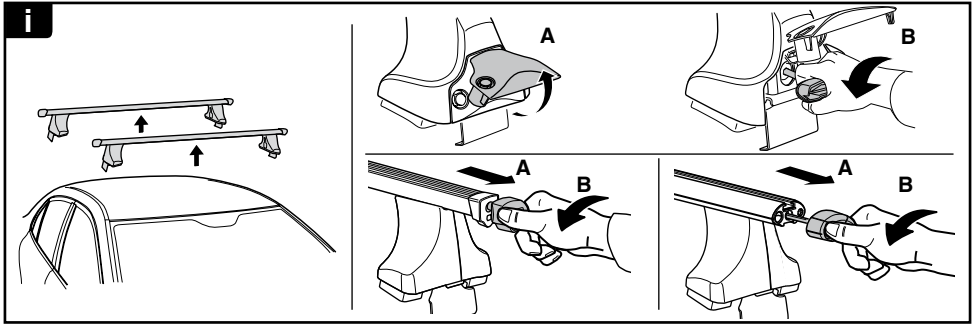

THULE
SWEDEN
**ONE
KEY
SYSTEM**



- 544 (x4)
- 596 (x6)
- 588 (x8)
- NA 510 (x10)
- EUR 452 (x12)
- ASIA



WW ▶ Thule Sweden AB, Box 69, 330 33 Hillerstorp, SWEDEN
NA ▶ Thule Inc., 42 Silvermine Road, Seymour, Connecticut 06483, USA

info@thule.com
customer.service@thule.com

www.thule.com

503-1459-02