

Kit 1595

VOLVO S80, 4-dr Sedan, 06- / *07-

*North America

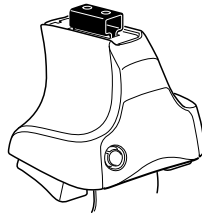

754 Rapid System
480R Rapid Traverse (North America)

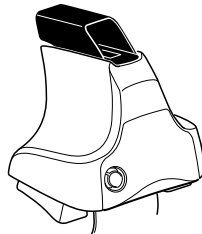

480 Traverse (North America)

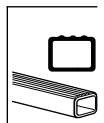

Max. 60 kg
Max. 132 lbs

THULE
Kit XXXX
instructions
THULE

x1

754 Rapid System
480R Rapid Traverse (North America)

x4 **x4**

754 Rapid System
480R Rapid Traverse (North America)

x1

480 Traverse (North America)

x4 **x4**

480 Traverse (North America)

x2 **x2** **x2** **x1** **x2** **x2** **x2** **x2** **x2** **x2** **x2** **x2** **x2** **x2** **x2**

23 mm **17 mm** **23 mm**

x4 **x4**

(North America)

204 x2 **815 x1** **817 x1**
206 x2 **816 x1** **818 x1**

x1

1

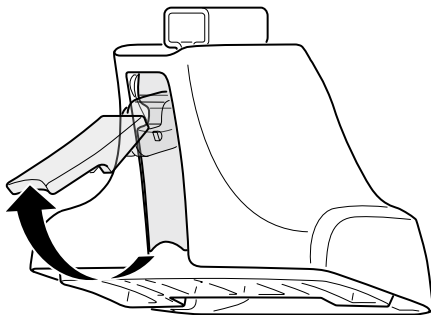

2



754 Rapid System
480R Rapid Traverse
(North America)

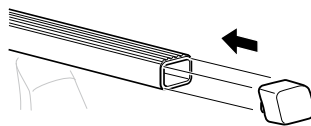
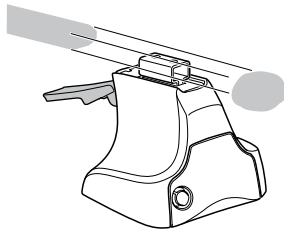

x4

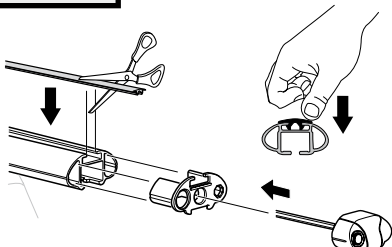

x4

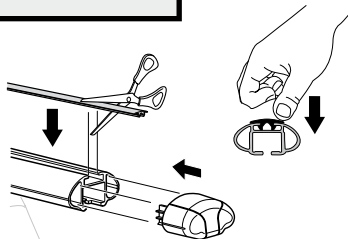
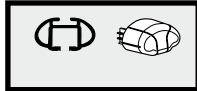

x4



480 Traverse
(North America)

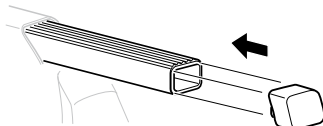
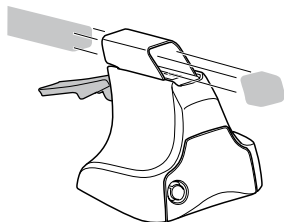

x4

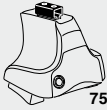
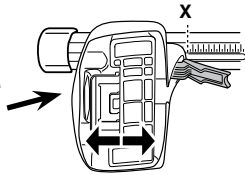
3**754** Rapid System

	X
VOLVO S80, 4-dr Sedan, 06- / *07-	44

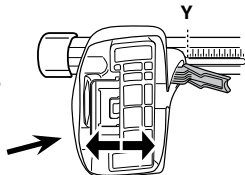

	Y
VOLVO S80, 4-dr Sedan, 06- / *07-	37,5

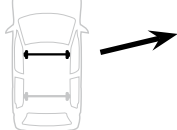
3**480R** Rapid Traverse**480** Traverse**(North America)**

	X inch	X mm
VOLVO S80, 4-dr Sedan, 06- / *07-	43"	1091 mm

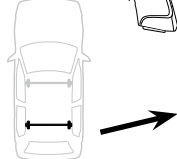

	Y inch	Y mm
VOLVO S80, 4-dr Sedan, 06- / *07-	40 3/8"	1026 mm

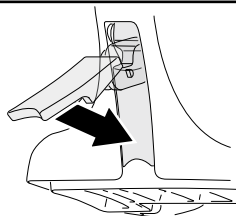
4

5

VOLVO S80, 4-dr Sedan, 06- / *07-

204



815



206

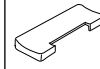

816



206



817



204

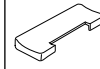

818



A

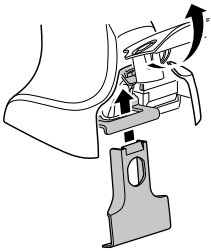

B

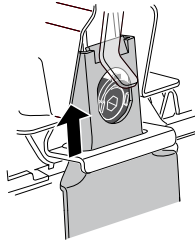

C

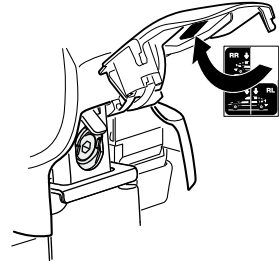
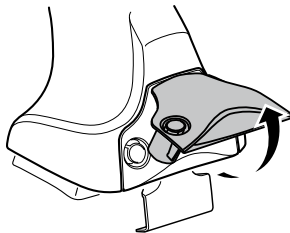
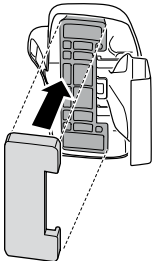
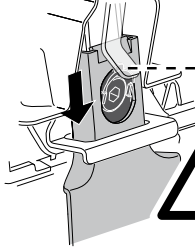

6

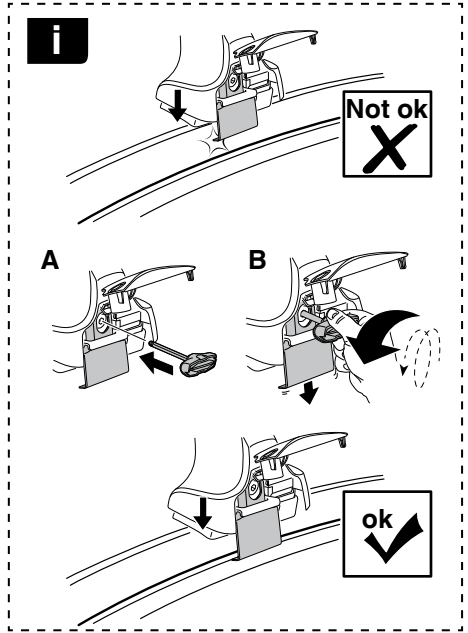
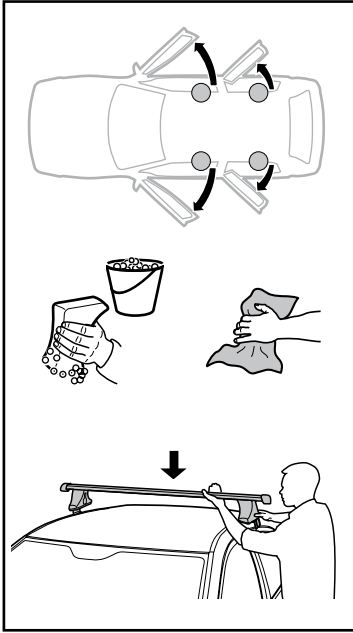

	X mm	Y mm	X inch	Y inch
VOLVO S80, 4-dr Sedan, 06- / *07-	240 mm	640 mm	9 1/2"	25 1/4"

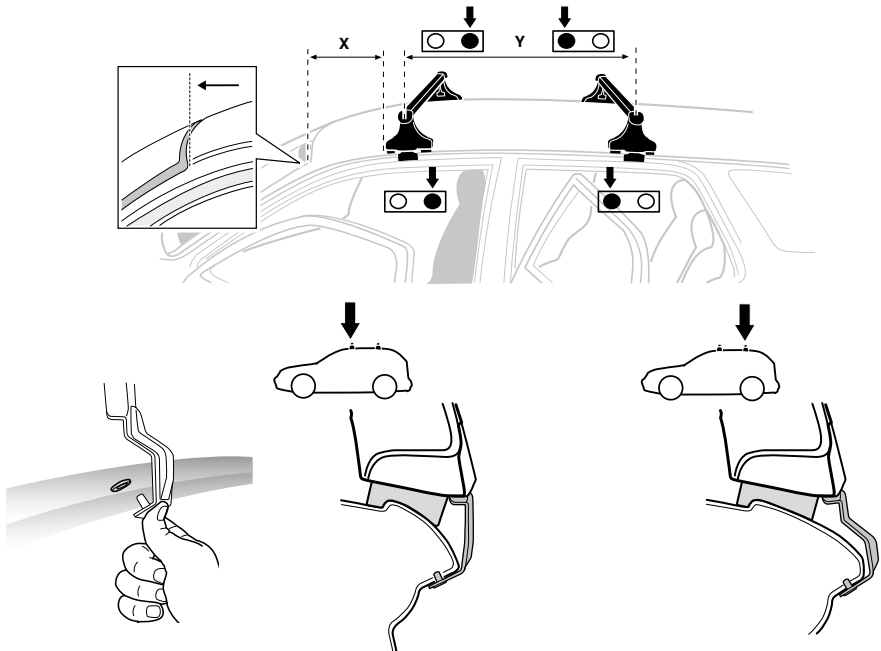

7

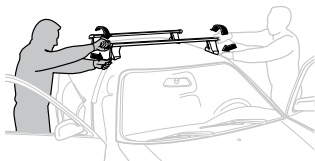

GB/US	Tighten alternately
D	Die Schrauben abwechselnd anziehen
F	Serrer alternativement chaque côté
NL	Afwisselend aan de linker- en de rechterkant aandraaien
I	Alternare il serraggio delle viti
E	Apretar alternativamente
PT	Aperte alternadamente
S	Dra åt växelvis
FIN	Kierrä vuorotellen
EST	Pinguldage vaheldumisi
LAT	Pielveiciet pamišus
LIT	Užsukinėkite pakaitomis
PL	Śruby dokręcaj naprzemiennie
RU	Загтягивайте попеременно

CZ	Pokręřta багаžnika dokręcaj naprzemiennie.
SK	Dofahajte striedavo
SLO	Privijajte izmenično.
HR	Naizmjenočno zategnite
HU	Egymástól függetlenül szorítandó
GR	Σφιγίγες εναλλάξ
TR	Dönüşümlü sıkın

中文 交替拧紧

한국어 번갈아 가며 조이십시오.

日本語 交互に締め付けてください。

ไทย ชั้นในแบบสลับ

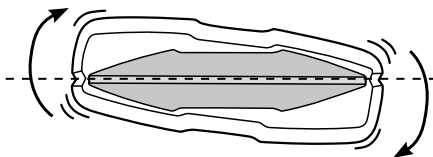
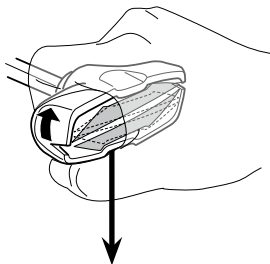
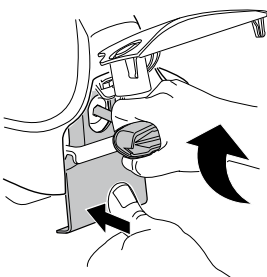
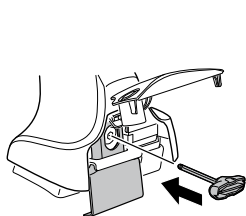

≈ 3 Nm

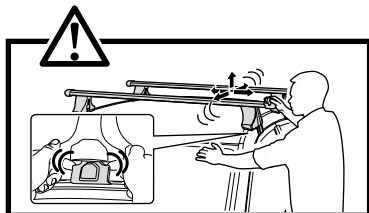
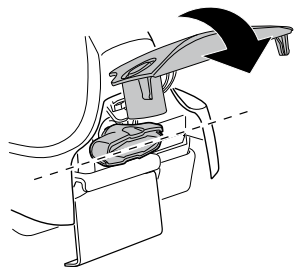

8



x1
17 mm

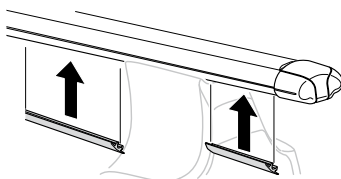

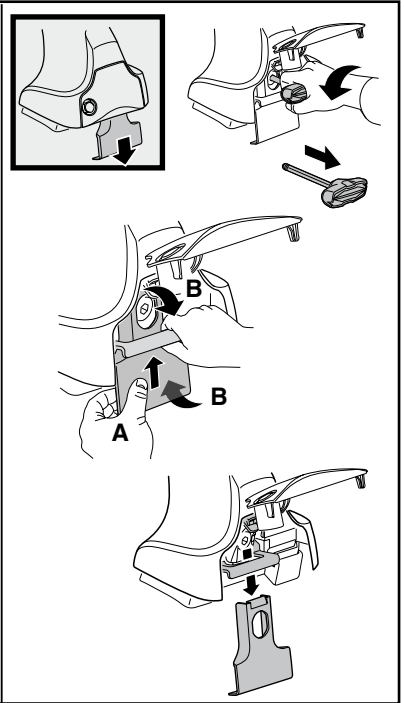
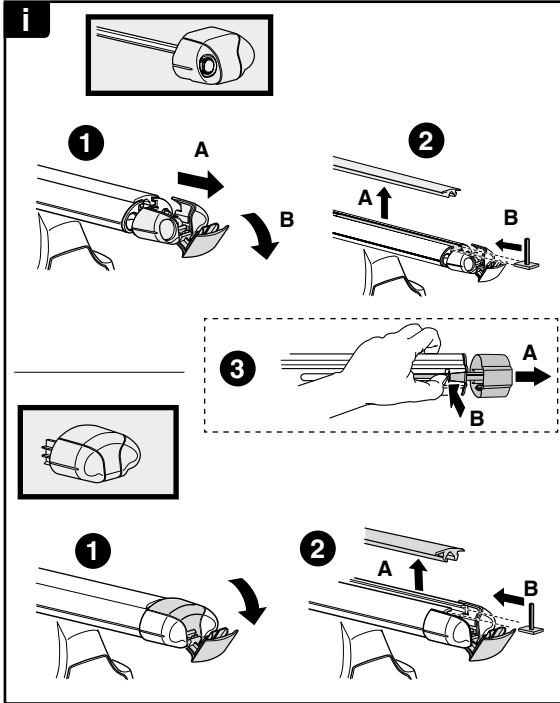

THULE
SWEDEN
**ONE
KEY
SYSTEM**

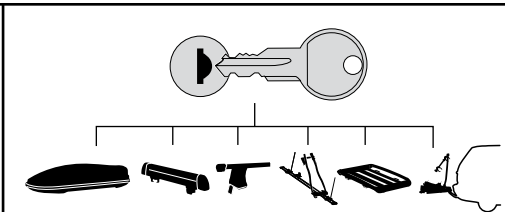

- 544 (x4)
 - 596 (x6)
 - 588 (x8)
 - 510 (x10)
 - 452 (x12)
- NA
EUR
ASIA



WW ▶ Thule Sweden AB, Box 69, 330 33 Hillerstorp, SWEDEN
NA ▶ Thule Inc., 42 Silvermine Road, Seymour, Connecticut 06483, USA

info@thule.com
customer.service@thule.com

www.thule.com