

Kit 1605

CITROËN C3, 5-dr Hatchback, 02-

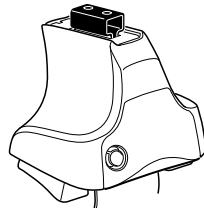

480R Rapid Traverse
754 Rapid System

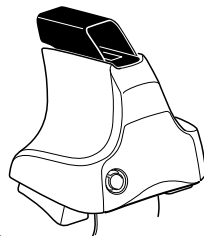
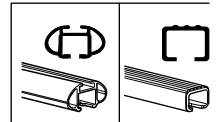

480 Traverse

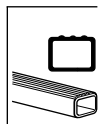

Kit

1

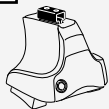

480R Rapid Traverse
754 Rapid System



480 Traverse

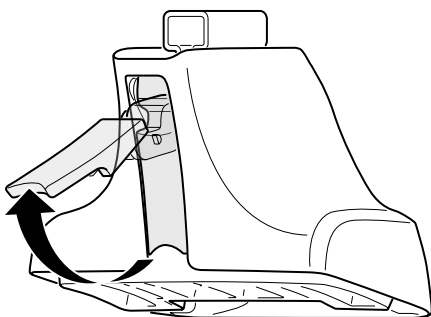

2

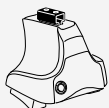

480R Rapid Traverse
754 Rapid System



480 Traverse

+

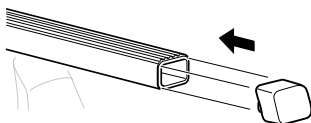
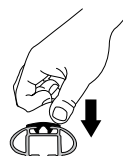
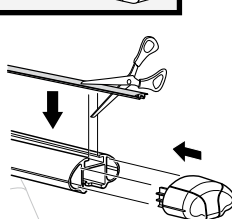
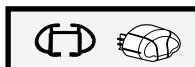
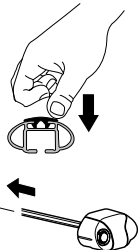
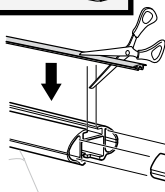
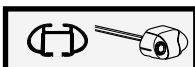
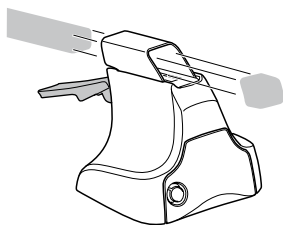
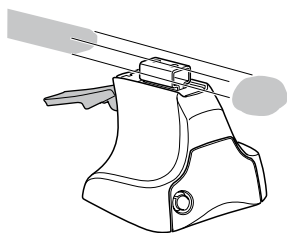

3

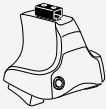

754 Rapid System

1

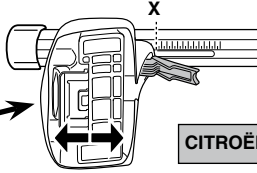
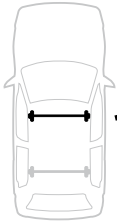

2

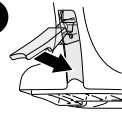

CITROËN C3, 5-dr Hatchback, 02-

X

33,5

1

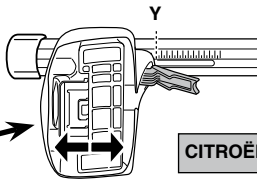
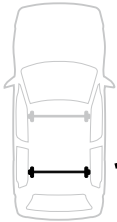

2

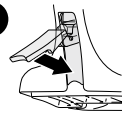

CITROËN C3, 5-dr Hatchback, 02-

Y

29,5



480R Rapid Traverse



480 Traverse

1

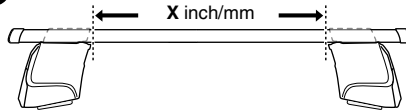

2

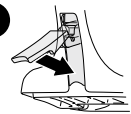

CITROËN C3, 5-dr Hatchback, 02-

X inch

X mm

38 ⁷/₈"

986 mm

1

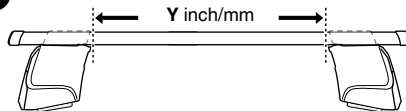

2

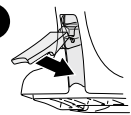

CITROËN C3, 5-dr Hatchback, 02-

Y inch

Y mm

37 ¹/₄"

946 mm

4

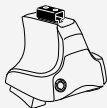

480R Rapid Traverse
754 Rapid System



480 Traverse

CITROËN C3, 5-dr Hatchback, 02-

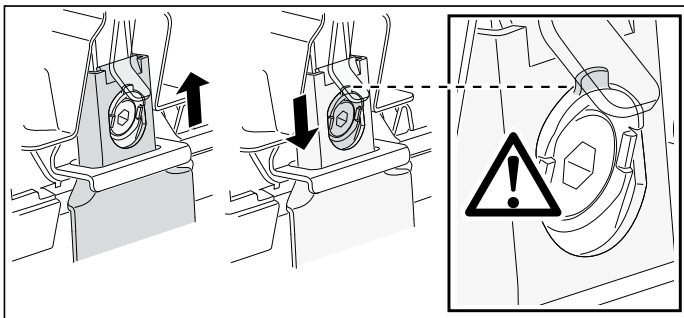
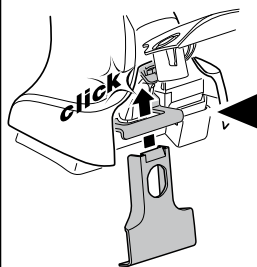
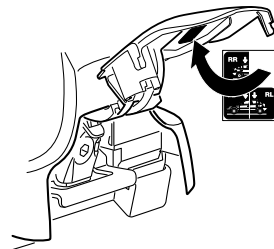
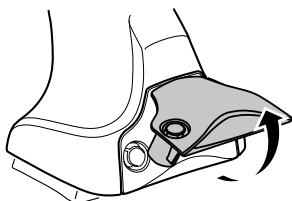
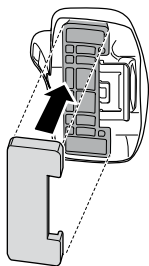
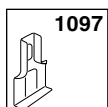
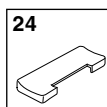
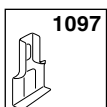
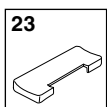
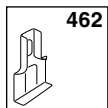
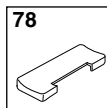
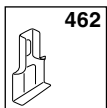
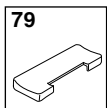

5



	X mm	Y mm	X inch	Y inch
CITROËN C3, 5-dr Hatchback, 02-	280 mm	650 mm	11"	25 5/8"

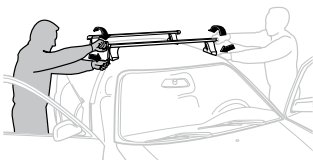
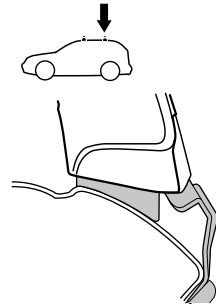
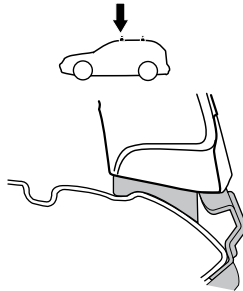
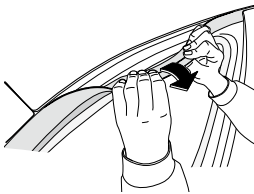
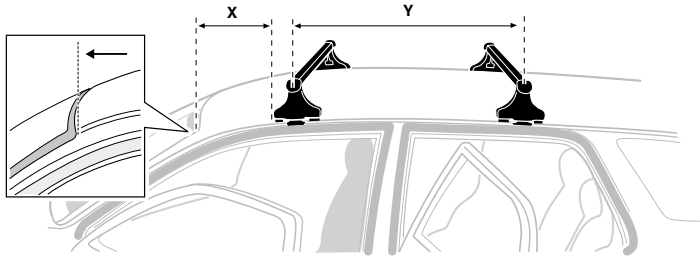

GB/US Tighten alternately
D Die Schrauben abwechselnd anziehen

F Serrer alternativement chaque côté

NL Afwisselend aan de linker- en de rechterkant aandraaien

I Alternare il serraggio delle viti

E Apretar alternativamente

PT Aperte alternadamente

S Dra åt växelvis

FIN Kierrä vuorotellen

EST Pinguldage vaheldumisi

LAT Pieļieciet pamāšus

LIT Užsukinkite pakaitomis

PL Śruby dokręcaj naprzemiennie

RU Затягивайте попеременно

CZ Pokrétla bagazníka dokręcaj dokręcaj naprzemiennie.

SK Dotahujte striedavo

SLO Privijajte izmenično.

HR Naizmjениčno zategnite

HU Egy mástól függetlenül szorítandó

GR Σφιγγετε εναλλάξ

TR Dönüşümlü sıkın

中文 交替拧紧

한국어 번갈아 가며 조이십시오.

日本語 交互に締め付けてください。

ไทย ชนในแบบสลับ

6

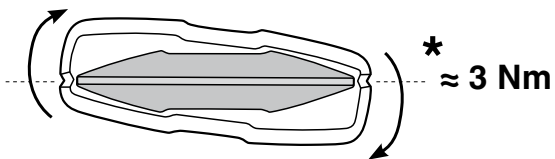
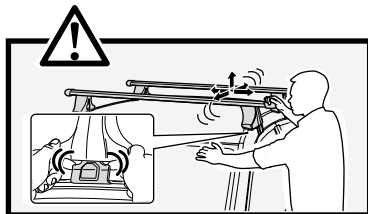
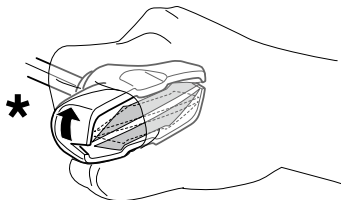
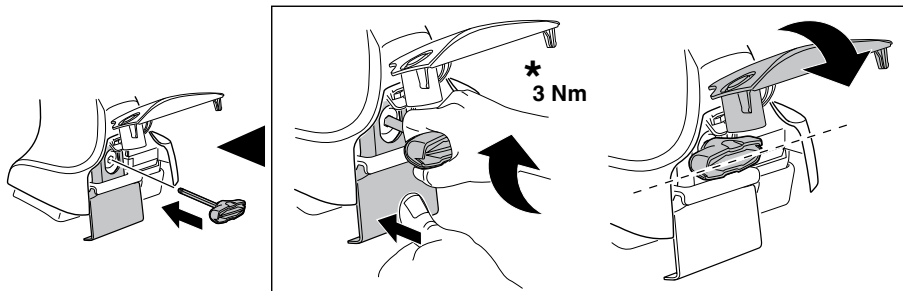
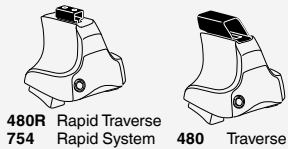

7

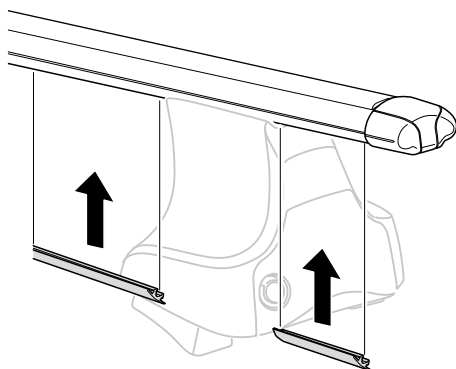
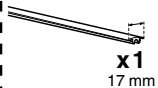

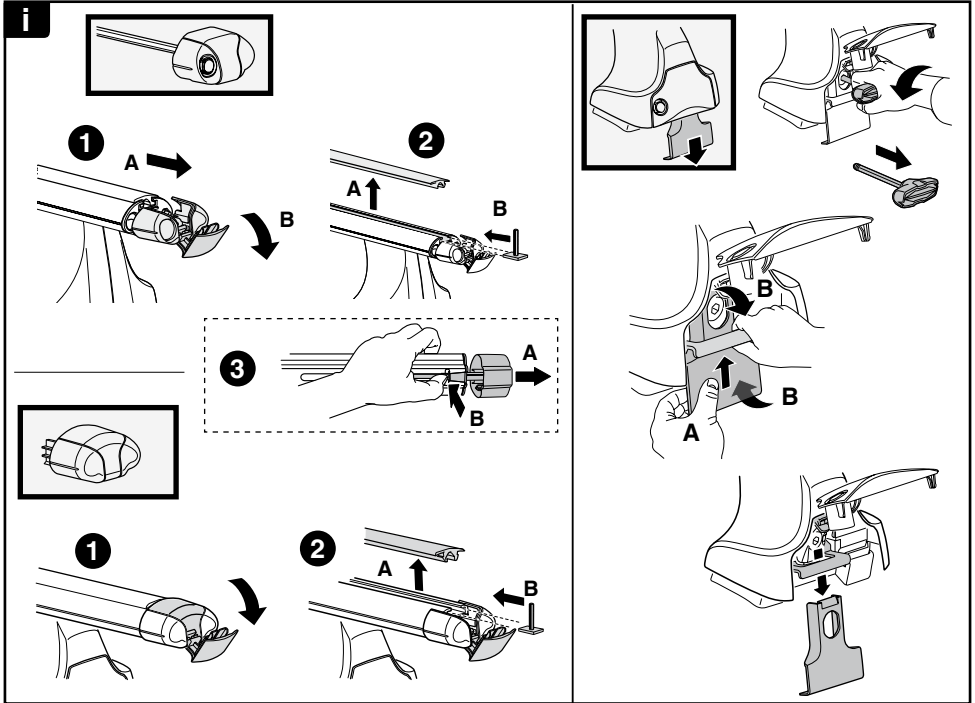

THULE
SWEDEN
**ONE
KEY
SYSTEM**

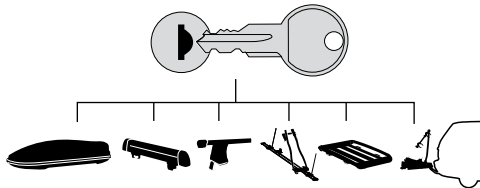

- 544** (x4)
- 596** (x6)
- 588** (x8)
- NA **510** (x10)
- EUR **452** (x12)
- ASIA

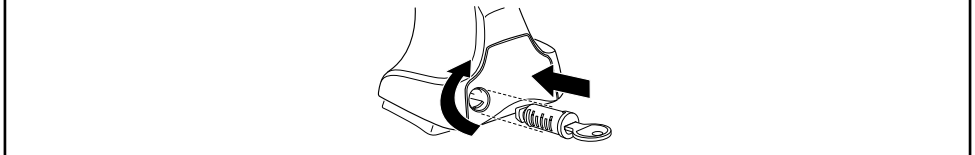

WW ▶ Thule Sweden AB, Box 69, 330 33 Hillerstorp, SWEDEN
NA ▶ Thule Inc., 42 Silvermine Road, Seymour, Connecticut 06483, USA

info@thule.com
customer.service@thule.com

www.thule.com