

Kit 1622

SUZUKI Swift, 5-dr Hatchback, 05-10

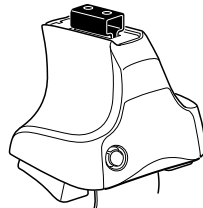

480R Rapid Traverse
754 Rapid System

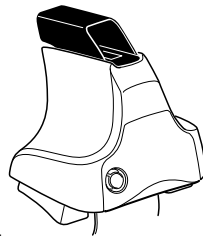
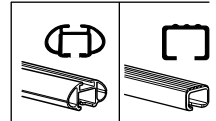

480 Traverse

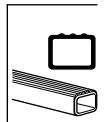

480R Rapid Traverse x4
754 Rapid System x4
480R Rapid Traverse x4
754 Rapid System x4
480 Traverse x4

- Bar (x2)
- Nut (x2)
- Washer 23 mm (x2)
- Washer 17 mm (x1)
- Washer 23 mm (x2)
- Washer 23 mm (x2)
- Screw (x4)
- Screw (x2)
- Screw (x4)
- Screw (x2)
- Bar (x2)

- 1115** x4
- 221** x4
- 503-1622** x1

Kit

1

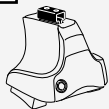

480R Rapid Traverse
754 Rapid System



480 Traverse

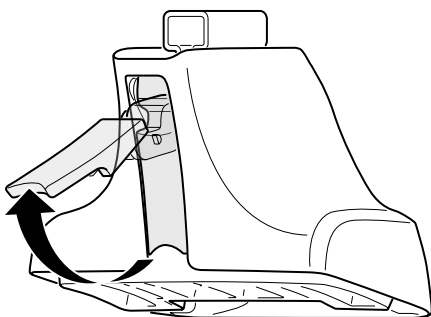

2

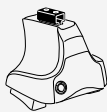

480R Rapid Traverse
754 Rapid System



480 Traverse

+

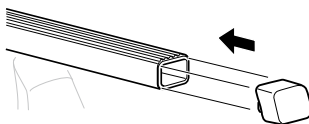
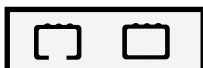
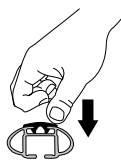
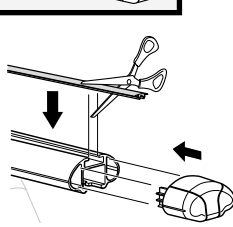
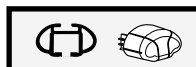
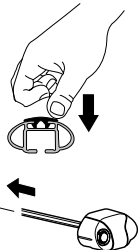
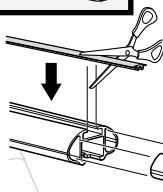
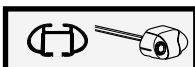
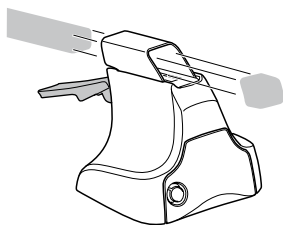
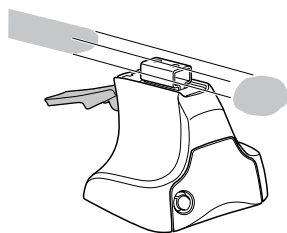

3

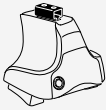

754 Rapid System

1

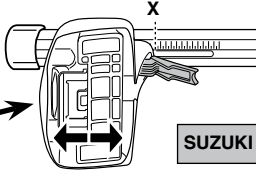
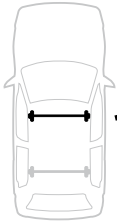

2

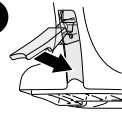

SUZUKI Swift, 5-dr Hatchback, 05-10

X

22

1

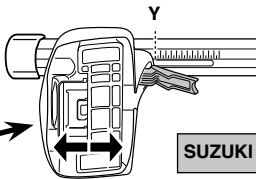
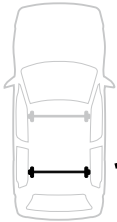

2

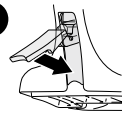

SUZUKI Swift, 5-dr Hatchback, 05-10

Y

18,5



480R Rapid Traverse



480 Traverse

1

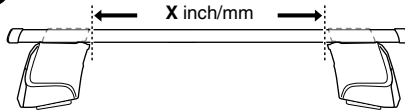

2

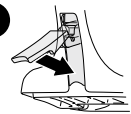

SUZUKI Swift, 5-dr Hatchback, 05-10

X inch

X mm

34 1/4"

871 mm

1

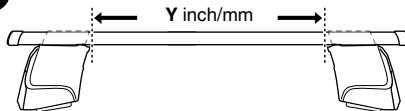

2

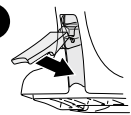

SUZUKI Swift, 5-dr Hatchback, 05-10

Y inch

Y mm

32 7/8"

836 mm

4



480R Rapid Traverse
754 Rapid System



480 Traverse

SUZUKI Swift, 5-dr Hatchback, 05-10

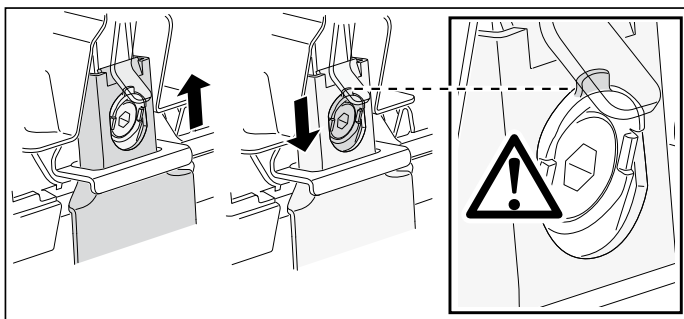
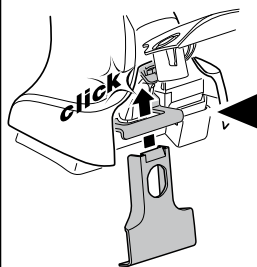
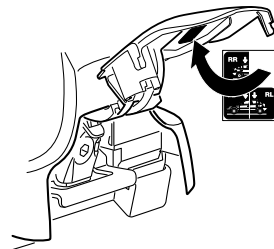
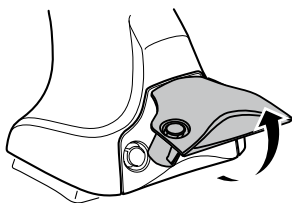
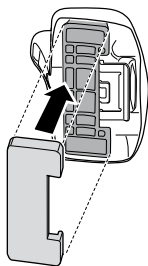
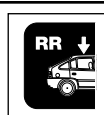
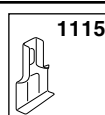
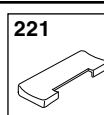
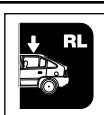
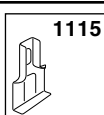
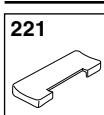
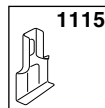
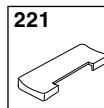
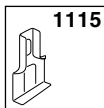
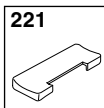

5



	X mm	Y mm	X inch	Y inch
SUZUKI Swift, 5-dr Hatchback, 05-10	270 mm	675 mm	10 5/8"	26 5/8"

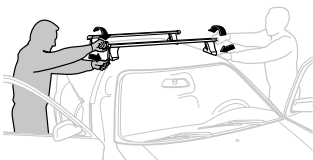
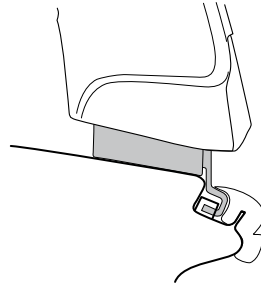
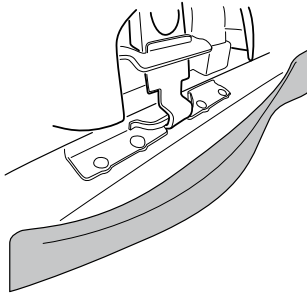
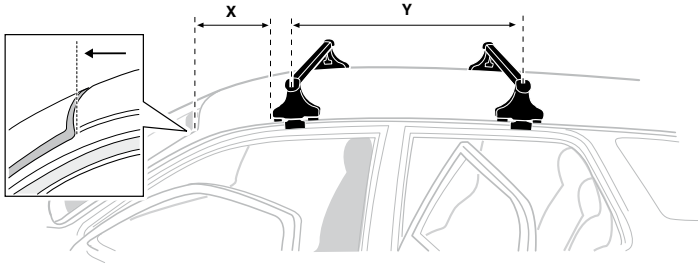

- | | | | |
|--------------|---|------------|---|
| GB/US | Tighten alternately | CZ | Pokreťta bagazníka dokreťaj dokreťaj naprzemiennie. |
| D | Die Schrauben abwechselnd anziehen | SK | Dofahajte striedavo |
| F | Serrer alternativement chaque côté | SLO | Privijajte izmenično. |
| NL | Afwisselend aan de linker- en de rechterkant aandraaien | HR | Naizmjениčno zategnute |
| I | Alternare il serraggio delle viti | HU | Egymástól függetlenül szorítandó |
| E | Apretar alternativamente | GR | Σφιγγετε εναλλάξ |
| PT | Aperte alternadamente | TR | Dönüşümlü sıkın |
| S | Dra åt växelvis | 中文 | 交替拧紧 |
| FIN | Kierrä vuorotellen | 한국어 | 번갈아 가며 조이십시오. |
| EST | Pinguldage vaheldumisi | 日本語 | 交互に締め付けてください。 |
| LAT | Pievēciēt pamāšus | ไทย | ขันในแบบสลับ |
| LIT | Užsukinkite pakaitomis | | |
| PL | Śruby dokrećaj naprzemiennie | | |
| RU | Затягивайте попеременно | | |

6

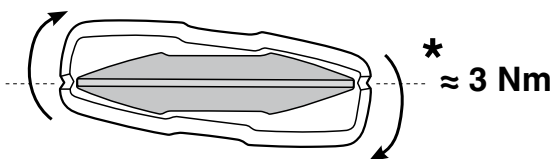
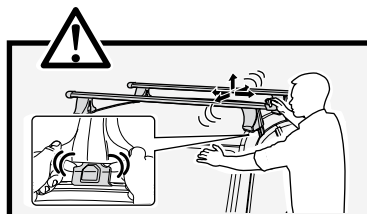
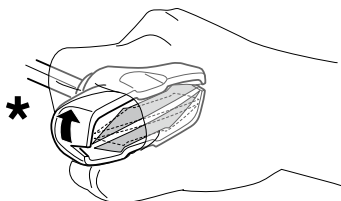
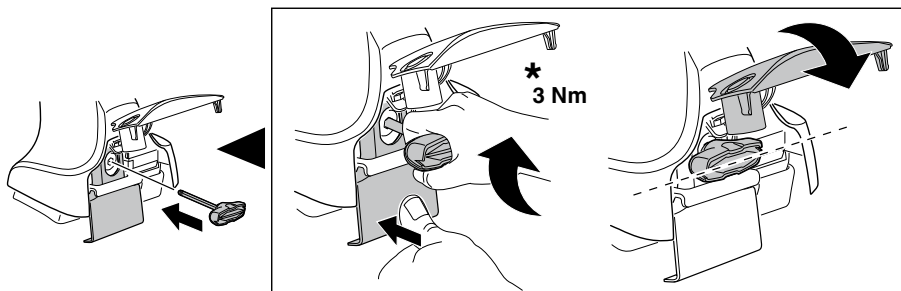
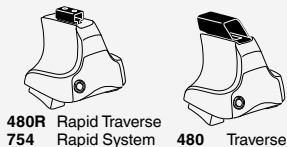

7

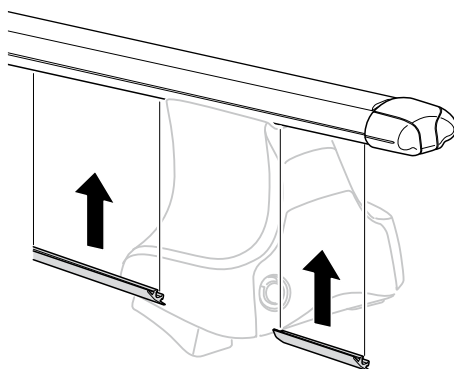
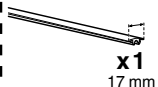

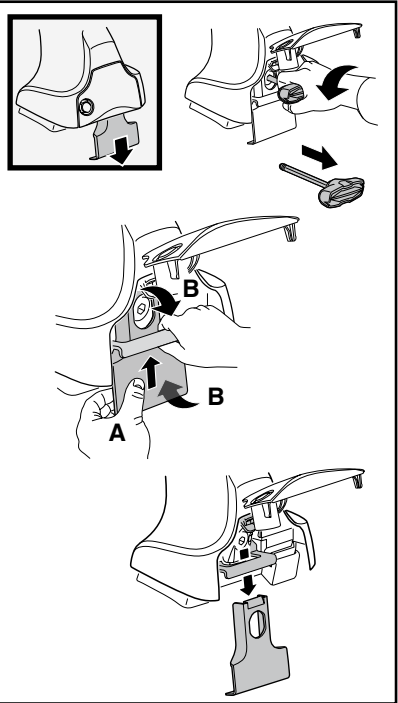
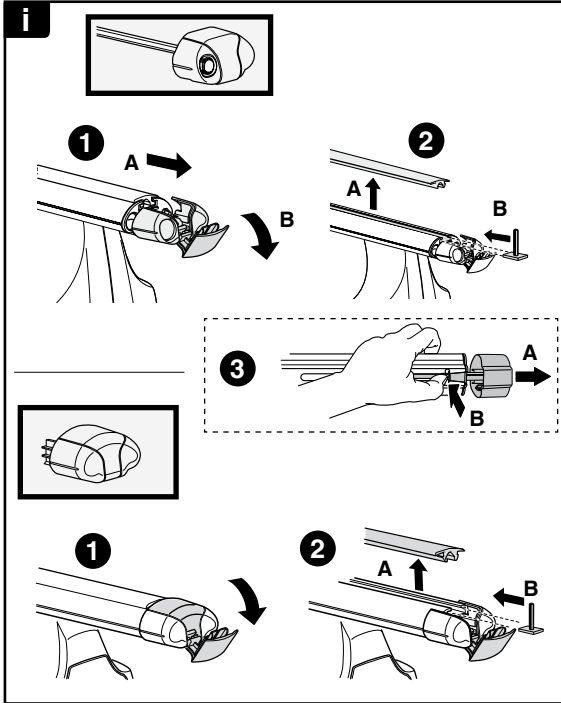
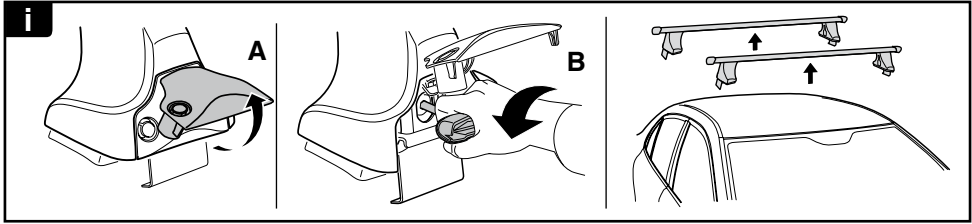

THULE
SWEDEN
**ONE
KEY
SYSTEM**

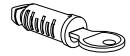
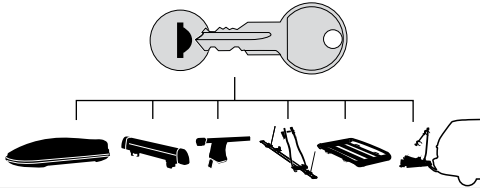

- 544** (x4)
- 596** (x6)
- 588** (x8)
- NA **510** (x10)
- EUR **452** (x12)
- ASIA

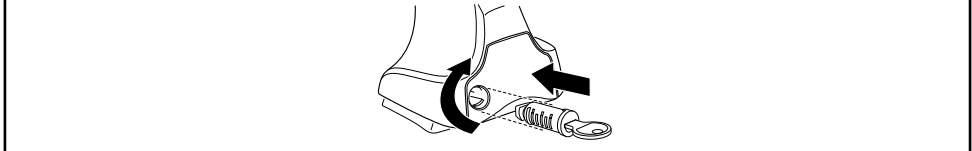

WW ▶ Thule Sweden AB, Box 69, 330 33 Hillerstorp, SWEDEN
NA ▶ Thule Inc., 42 Silvermine Road, Seymour, Connecticut 06483, USA

info@thule.com
customer.service@thule.com

www.thule.com